

SECTION 10 14 00

SIGNAGE

PART 1 – GENERAL

1.1 PURPOSE

- A. This guideline is intended to provide useful information to the Professional Service Provider (PSP) to establish a basis of design. PSP is to apply the principles of this section such that the University of Texas at Arlington (UTA) may achieve a level of quality and consistency in the design and construction of their facilities. Deviations from these guidelines must be approved by UTA and may require justification through Life Cycle Cost (LCC) analysis and submitted to UTA for approval.

1.2 LESSONS LEARNED AND DESIGN CONSIDERATIONS

- A. **UTA Sign Shop to provide and install all ADA signage for rooms, including mechanical, electrical, and elevator machine rooms.**
- B. **UTA EH&S department will provide Fire Safety signs.**
- C. **UTA Sign Shop to provide and install Evacuation diagrams.**
- D. **All other signs to be provided by Contractor. These signs shall comply with branding identity guidelines established by the UTA University Communications department. Shop drawings and submittals must be approved by this department prior to fabrication.**

1.3 SECTION INCLUDES

- A. Building identification signs.
- B. Building fascia letters.

1.4 RELATED REQUIREMENTS

- A. Section 10 14 16.11 - Cast Bronze Dedicatory Building Plaque.

1.5 SUBMITTALS

- A. See Division 01 for submittal procedures.
- B. Product Data: Manufacturer's printed product literature for each type of sign, indicating sign styles, font, foreground and background colors, locations, overall dimensions of each sign.
- C. Samples: Submit two samples of each type of sign, of size similar to that required for project, illustrating sign style, font, and method of attachment.
- D. Selection Samples: Where colors are not specified, submit two sets of color selection charts or chips.
- E. Manufacturer's Installation Instructions: Include installation templates and attachment devices.

1.6 QUALITY ASSURANCE

- A. Manufacturer Qualifications: Company specializing in manufacturing the products specified in this section with minimum three years of documented experience.

PART 2 – PRODUCTS

2.1 PLAQUES - REFER TO SECTION 10 14 16.11

- A. Uni-color resilient homogeneous tackable linoleum surface consisting of linseed oil, granulated cork, rosin binders, and dry pigments calendared onto natural burlap backing. Color shall extend through thickness of material.

2.2 DIMENSIONAL LETTERS – BUILDING FASCIA

- A. Metal Letters:
 - 1. Material: Cast aluminum, water jet cut.
 - 2. Height: 14 inch.
 - 3. Thickness: 3/8 inch.
 - 4. Finish: Anodized Dark Bronze.
 - 5. Style/Font: Helvetica.

GUIDE SPECIFICATIONS FOR DESIGN AND CONSTRUCTION DOCUMENTS

6. Mounting: Stud mount.
 - a). Projection: Flush to building.

PART 3 – EXECUTION

3.1 INSTALLATION

- A. Install in accordance with manufacturer's instructions.
- B. Install neatly, with horizontal edges level.
- C. Locate signs where indicated.
- D. Protect from damage until Substantial Completion; repair or replace damage items.

PART 4 – APPENDIX

4.1 PRODUCT DATA / CUT SHEETS

- A. Dimensional Letter: Shop Drawing

END OF SECTION

14'-2"

NEDDERMAN HALL

14"

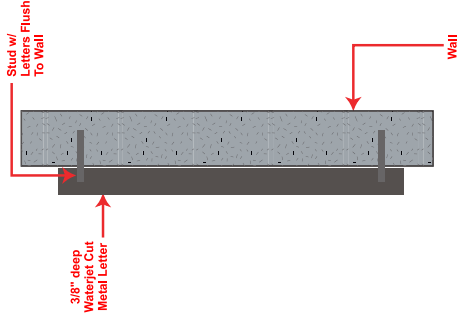

Metal Letters



- Supply and install set of waterjet cut flat metal letters for building fascia.
- 3/8" thick aluminum letters are 14" H Helvetica text with Anodized Dark Bronze finish. Letters to be stud mounted flush to fascia.

Proposed signage placement. (Rendition only - Artwork may not be to scale).

Customer Approval _____ Date _____



745 109th Street
Arlington, TX 76011
Metro 817-640-6441

Nedderman Hall
501 1st Street
Arlington, TX 76019

3/6/2014
Design # 20378aV1

This is an original unpublished drawing submitted in connection with a project we are planning for you. It is not to be copied, reproduced, exhibited or shown to anyone outside your organization without the written permission of Hancock Sign Company.
Contractor License #18032 Regulated by the Texas Department of Licensing and Regulation, P.O. Box 12157, Austin, TX 78711 (512) 463-6599 Toll-Free (800) 803-9292