

STUDENT SCHEDULE PLANNER

1 LOGIN

Go to www.uta.edu/mymav
Log In, Click Student Center,
Click "Schedule Planner"

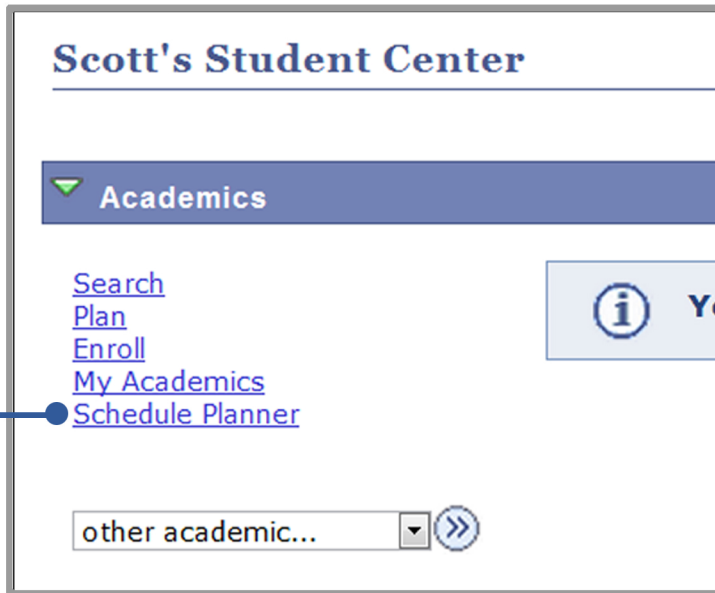

2 CLICK "SCHEDULE PLANNER"

"Click Here" To Easily Plan Your
Class Schedule

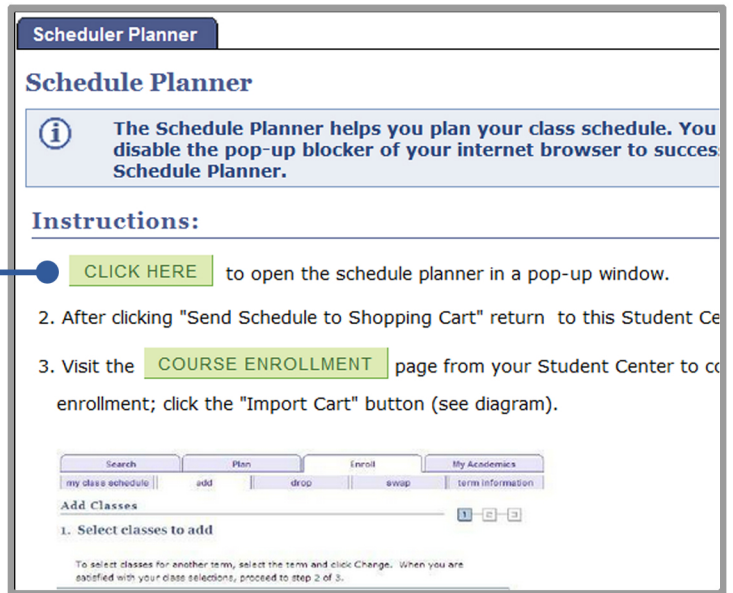

3 ADD COURSES

To Take Next Term

4 ADD BREAKS

To Block Off Times
For No Class

5 GENERATE

All Possible Schedules

6 VIEW

To See Each Schedule

7 SEND TO SHOPPING CART

From the "View" Screen, Click the "Shopping Cart" Button to Begin Registration!

